

Design Data	
Commutation	Brushed
Direction of rotation	Bi-directional
Bearing type	A:Ball - B:Sleeve

Performance data		
Rated voltage [V]	U_N	12
Nominal torque [Nm]	M_N	0.08
No-load speed [min^{-1}]	n_0	2,700.0
Nominal power [W]	P_N	16.2
Nominal current [A]	I_N	2.0
Nominal force [kN]	F_N	0.00
Duty cycle	s3	

Sensor data	
Pulses	0
Output channels	0

Other data	
Gear ratio	
Gear wheel material	
Suppression components	7,5 μ H
Enclosure class	IP 30
Weight [kg]	0.550

Remarks:

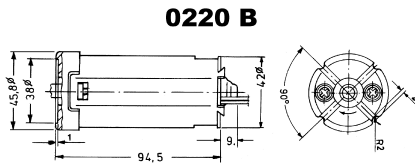

Motor picture

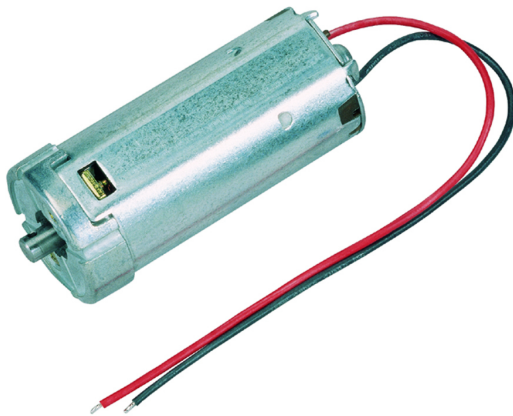

Characteristic curves

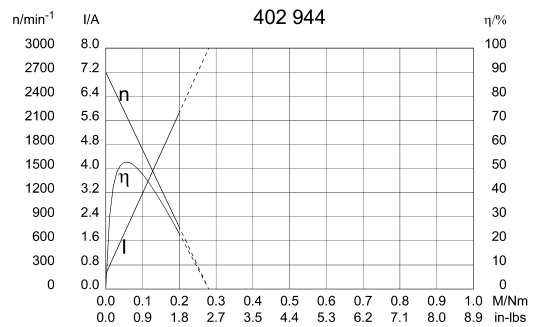

Output shaft drawing (W), Wiring diagrams (S) and Connector layout (K)

